

CAD/CAM COMPONENTS | TI-BASES FOR INTERNAL HEX IMPLANTS

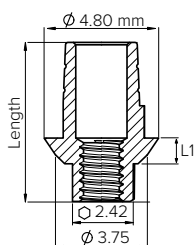

(*) IN SIRONA CEREC SYSTEM
CHOOSE ZIMMER TAPRED SCREW
VENT 3.5mm PLATFORM

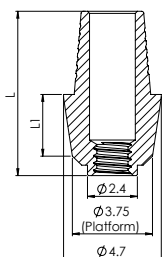

| | |
|-------------------|---|
| DESIGN FEATURES | <ul style="list-style-type: none"> • Anti-rotational and non-engaging design • Range of Gingival heights |
| CLINICAL BENEFITS | <ul style="list-style-type: none"> • Cement retained abutments • Gingival Collar height selection • Range of emergence profiles abutment options |
| MATERIAL | <ul style="list-style-type: none"> • Titanium Alloy (Ti-6Al-4V ELI) |

ORDERING INFORMATION

| Single Unit Titanium Base for Crown | Ø D (mm) | L (mm) | L1 (mm) | Ref. No |
|-------------------------------------|----------|--------|---------|----------|
| | 4.8 | 4.5 | 0.7 | NM-C2201 |
| | 4.8 | 6.0 | 2 | NM-C2212 |
| | 4.8 | 7.0 | 3 | NM-C2213 |
| | 4.2 | 6.8 | 0.3 | NM-C2230 |

| Non-Hexed Titanium Base for Bridge | Ø D (mm) | L (mm) | L1 (mm) | Ref. No |
|------------------------------------|----------|--------|---------|----------|
| | 4.8 | 5.5 | 0.6 | NM-C2202 |
| | 4.8 | 6.9 | 2 | NM-C2222 |
| | 4.8 | 7.9 | 3 | NM-C2223 |

| | | |
|--|--|------------------|
| | Included with all abutments & available separately | Ref. No NM-S8324 |
|--|--|------------------|



Noris Medical's CAD/CAM libraries are available for the following software: Exocad, 3Shape and Dental Wings. The most current libraries can be found in Noris Medical's website.

exocad

3shape

dental wings